

The Beacon

MONDAY, JANUARY 10, 2000

William Paterson University • Volume 66 No. 16

<http://euphrates.wpuj.edu/beacon> FREE

William Paterson University 'beefs up' campus security

By Ryan Caiazzo
News Editor

As you are walking through the lobby of your residence hall or taking a short cut through the Machuga Student Center to catch a class across campus, smile—you may be on William Paterson camera.

The installation of additional surveillance cameras is just the tip of the iceberg as William Paterson University Police and Public Safety enter the year 2000 with a new approach to campus-wide security. Throughout the spring semester, security enhancements will continue to increase safety and provide a higher, more efficient level of protection to the 10,000 students who attend WPU.

Dean Laumbach, Interim Director of Public Safety at WPU, says that the university is actively pursuing increased safety on campus through community policing. "It's a matter of controlling quality of life. We want to make William Paterson conducive to learning by providing a safe environment."

Community policing at WPU will entail a police substation to be constructed in the Towers lobby where an on duty police officer will be available to assist students in

the afternoon and evenings with police matters, parking permits and problems. The substation is expected to open some time this spring. Additionally, a new public safety officer will be interning to act as a liaison between students and the police.

Laumbach said that community policing efforts also entail surveying students on issues of adequate outdoor lighting and other safety concerns. "Feedback from students will be essential to community policing," said Laumbach.

Student Patrols

Laumbach said the student patrol program will be doubling its current capacity to increase safety on campus. "Student patrols are the eyes and ears on campus," said Laumbach.

Patrols will be both mobile and on foot and will be in contact with the University Police dispatcher by two-way radio to report any suspicious activity or summon police officers for help during any type of emergency. Patrols will also be able to escort students who are concerned with their safety.

The student patrol program is scheduled to operate from early evening till 10 p.m. each night. About two patrols will be on duty

at night in addition to the usual three police units. Students interested in becoming members of the patrol can contact Laumbach at 720-2301.

Surveillance Cameras

A sophisticated indoor and outdoor surveillance camera system that will monitor public areas of every building and all parking lots on campus is being planned.

"The system will allow the (police) dispatcher to monitor areas and send police units where needed," said Laumbach. According to Laumbach, some WPU employees who are experts in the security industry are developing a proposal that will call for the installation of a fiber optic camera system which will be "event driven."

The system will employ the use of motion detectors to activate cameras and send real-time video signals to the police monitoring room. This will reduce eye strain on the person monitoring the television screens because only cameras where action is occurring will send video signals, as opposed to a constant image signal on a screen where there is no movement. The system will be recorded 24 hours per day.

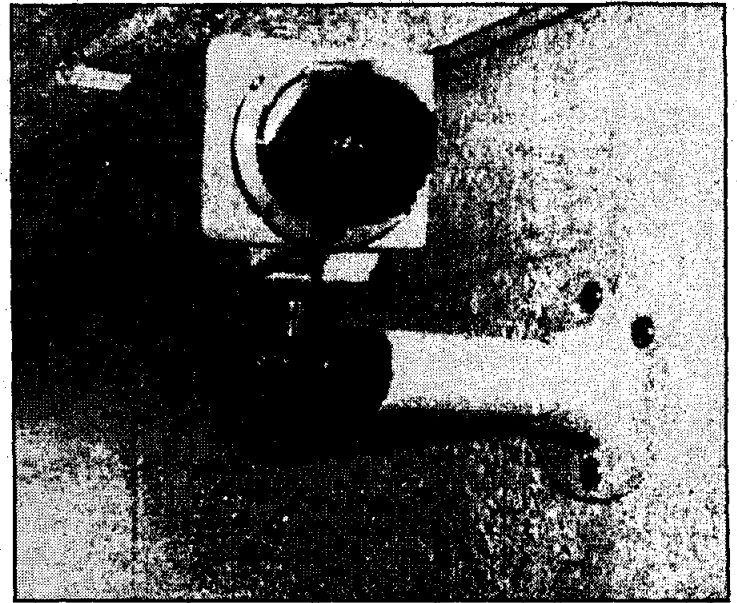

photo by Ryan Caiazzo/The Beacon

Surveillance cameras are just one of the many improvements that William Paterson University is implementing to enhance campus security for more than 10,000 students and faculty.

Some students may be concerned that the camera system is an invasion of privacy. But as Laumbach describes, the system is being developed only to enhance security.

"You can't say that big brother is watching because the cameras will only be in public areas. We are not

going to go into areas where we don't belong," said Laumbach.

Provost Chernoh Sesay said that every dormitory lobby on campus will be monitored by closed circuit television. Laumbach added that the Askew Library also has cam-

see NEW page 3

University institutes extensive improvements during winter break

Parking, Food Service, Security issues addressed

By Ryan Caiazzo
News Editor

Like dandelions on a freshly mowed lawn, students and faculty will notice new parking signs as they drive onto campus. These signage improvements are just some of the many widespread enhancements that the university has been implementing over winter break to better serve the William Paterson community.

As the spring semester commences, students will be discovering that many changes have been implemented or are in the process of being executed on campus—changes in parking regulations, food service and security.

At a meeting on Dec. 2, 1999, the Student Government Association

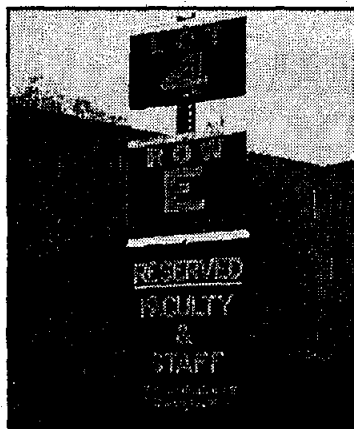

photo by Ryan Caiazzo/The Beacon

New parking signs are just some new changes made to campus over winter break.

discussed several areas of concern with Provost Chernoh Sesay and

other high ranking university administrators. As a result of this conference, several resolutions were made by Sesay to answer the concerns, complaints and problems students introduced.

"I feel good that we are doing all we can to improve the quality of life for students and faculty and we will continue to do so," said Sesay.

Sesay said that the changes being initiated are only the beginning. "We are planning to build a parking garage in lot two to provide more student spaces," Sesay said. An outdoor closed-circuit television surveillance system is slated for installation in the future to enhance security efforts at WPU. The system will be monitored by

see PROVOST page 5

37 WPU students receive national Who's Who distinction

By Ryan Caiazzo
News Editor

The qualifications are lengthy: you need to have a strong academic background, be an active leader in an on campus organization or extra-curricular activity and provide service to your community.

For 66 years, *Who's Who Among Students in American Universities and Colleges* has been honoring students who combine academics, leadership and service to their communities and campuses. Students who are nominated to receive the award must meet eligibility requirements and provide letters of recommendation to the nominating committee.

The nomination process began prior to October and ended at the conclusion of the fall 1999 semester. Nine representatives from the Office of Campus Activities at William Paterson University met to

decide which applicants were deserving of the distinction.

According to Robin Parr, Director of Campus Activities, these student and staff committee members ranked each applicant using a numerical point system. Each category of academics, service to William Paterson University and service to the community was evaluated on an individual basis. Scores for each student were tabulated and statistical techniques applied to determine which students should be honored.

The criteria for eligibility into *Who's Who* include:

*A minimum GPA of 2.5 for undergraduate and 3.0 for graduate students;

*Matriculated full-time or part-time junior (58-89 earned credit hours) or graduate student participation in extracurricular activities;

see CAMPUS page 3

News

Transfer Registration

Page 3



Insider

The Talented Mr. Ripley

Page 7



Sports

Women's Basketball

Page 12



EARN \$10 to \$12 an HOUR

Immediate Openings For:
Reliable, goal oriented students or non
students who want to make money
by helping renew existing accounts

Benefits include:

- Walking distance from WPUNJ
- Very flexible hours
(am, pm ,weekends)
- Paid Training
- Weekly Paycheck
- Bonuses



Call Today!

**Tell a friend, find out about lucrative
 referral bonuses (973) 595-6800**

ATTENTION DEPARTMENTS AND STUDENT ORGANIZATIONS:

The Campus Calendar is a
 FREE weekly listing of
 meetings and events at
 William Paterson University.
 The only catch: you need to
 let us know what is
 happening. Fill out a
 Campus Calendar form in
 the Beacon, SC 310.

**Advertise in the Beacon –
 Reach out to 10,000
 students every week**
 Call (973) 720-2571
 for more information

To The Campus Community, January 10, 2000

During the Fall 1999 semester two complaints of alleged sexual assault were reported to Public Safety. These complaints generated many rumors and some students became fearful about their personal safety on campus. The University took both the complaints and the rumors very seriously.

Provost Sesay appointed a Task Force to investigate the rumors and to provide accurate information to the campus community. It is essential that students feel safe and have accurate information so that they can know that they are safe.

The facts are: Two separate complaints of alleged sexual assault were reported to Public Safety. Both complaints were thoroughly investigated and the two investigations were completed by November 2, 1999. Both cases have been closed with no findings of actual sexual assault in either case.

Most sexual assaults go unreported and in many cases the two individuals are known to each other. The purpose of the Task Force is to serve as a resource to which you can turn if you feel that you or someone you know of has been sexually assaulted. The Task Force will submit recommendations for increasing WPU's educational efforts to empower all students, faculty and staff to be safe from sexual assault. Educational programming with campus community will be a major focus of the Task Force's work in the Spring 2000 semester

Task Force members include:

Paul Bonney, Editor-in Chief of The Beacon - Ext. 3264
 Lynette Shaw Butler, Public Safety - Ext. 2301
 Andrew Crawford, Student Rep. to the University Board of Trustees - Ext. 4169
 Dorian Douglas, Campus Activities - Ext. 2519
 Nancy Ellison, RN, MSN, CS, FNP, Health & Wellness Center - Ext. 3176
 Dr. Bonita Hampton, Women's Studies - Ext. 3680
 Dr. Rose Mary Howell, Assoc. Dean of Enrollment Management - Ext. 2740
 Dr. Nina Jemmott, Assoc. VP & Dean of Graduate Studies & Research- Ext. 3093
 Dr. Jean Levitan, Community Health - Ext. 2216
 Aubyn Lewis, Counseling Center - Ext. 2506
 Samantha Lugo, Exec. VP of the SGA - Ext. 3256
 Maximina Rivera-Burrowes, Residence Life - Ext. 3166
 Dr. Robert Rosen, English & Coordinator of the Race & Gender Project- Ext. 3062

Faculty and staff members can also be e-mailed by: last name, 1st initial @ wpunj.edu

the Beacon

A NEWSPAPER THAT'S CLEARLY FOR YOU

Paul Bonney
 Editor in Chief

News Editor Ryan L. Caiazzo

Sports Editor Laurie Quinlan

Insider Editor Andrew E. Semegram

Photo Editor Laurie Koba

Business Manager Matthew Halpern

Web Page Manager Mark R. Brown

Staff Writers

Albert Burton, Susan Daubaur, Frederick Doot,
 Christina Dufrasne, Jennifer Fletcher, Aaron Kinsman,
 Will Lawson, Alexis C. Nieto, Erik Ortiz,
 Mark Fonseca Rendeiro, Renee Romanelli,
 Katherine Scala, Caroline Schmidt, Michael K. Wnoroski

Staff Photographers

Sylvana Meneses, Marjorie Hanus,
 Tomasita Lopez

Academic Advisers

Elizabeth Birge and Muroki Mwaura

Financial Services Provided By
The Student Government Association of WPUNJ

The Beacon is published on Monday, and serves Haledon, North Haledon, Wayne, and the William Paterson University community. The business and editorial offices are located on the campus of William Paterson University in the Student Center, Room 310, Wayne, New Jersey 07470, (973) 720-2248. The Beacon receives no money from William Paterson University or its student body and therefore relies solely on advertising revenue to operate.



Campus Activities announces WPU recipients of *Who's Who* award

from 37 page 1

*The holding of one or more offices in an organization or excellence in an extracurricular pursuit;

*Service to the outside community; and

*Contribution to the William Paterson University community

"Who's Who is a beneficial program because it is open to any major and is not focused solely on academics—community and campus involvement are important factors," said Parr.

In all, 53 students were nominated, but only 37 were selected. A directory of all recipients is due out some time this year.

Recipients for 1999-2000 were:

Janice Acosta, Elizabeth Blanco, Ryan Caiazzo, Helen Chmelowitz, Gina Dounelis, Kim Eliaz, Sara Evans, Dana Feltz, Curtis Fields, Sheri Freeman, Daniel Ganev, Danielle Goleskie, Linton Gooden, Kelly Henning, Nokeima Holloway, Nathaniel Jones, Elizabeth Leon, Adrienne LuBrant, Samantha Lugo, Lakiesha Mays, Jennifer Moretti, Allison Morgan, Whitney Olson, Maria Ortiz, Tara Pankiewicz, Amanda Pittarell, Leah Prescott, Meghan Renna, Myra Rivera, Sarah Rodis, Tuwisha Rogers, Dana Romatowski, Carolyn Saladi, Morgan Small, Kamara Taylor, Vennansha Williams and Sybil Wilmot.

New security initiatives implemented on campus to increase student safety

from WILLIAM page 1

eras and that temporary surveillance can be set up in areas where monitoring is needed for special events, with the permission of Arnold Speert, University President.

The Machuga Student Center recently upgraded its camera system to monitor additional areas of the building.

"We've always had cameras in the student center. We just added 10 more for a total of 24," said Tony Cavotto, Director of Hospitality Services and head of the Machuga Student Center.

"When we decided to open the student center to students 24 hours per day, we decided to install more cameras to increase security," added Cavotto. Last March, 62.1 percent of 261 students surveyed said that the Student Center should be open 24 hours, Cavotto said.

Starbucks coffee, the arcade and the information desk are now open 24 hours as a result of students' response to the survey.

According to Cavotto, each camera is recorded on tape 24 hours per day. Money for the system came from the general renovation fund that provided many improvements to the Student Center. A monitoring station is set up behind the Student Information and Referral desk in the Student Center

lobby.

Cavotto believes that the camera system will not only capture a record of occurrences inside the building, but will prevent many incidents from happening. "(The cameras) are more of a deterrent than for investigation," said Cavotto.

Robin Parr, Director of Campus Activities, said that metal detectors for use at Billy Pat's Pub during special events have been ordered to increase security.

Two walk-through units ("gates") and four hand-held wand devices will be used to detect weapons on patrons before they are permitted to enter the premises.

Sesay said, "The suggestion to install (the metal detectors) came from students at last year's speak-out. We are answering their request and making it safer for everyone."

Sesay added that cameras have prevented less disorderly incidents in the lobbies of the residence halls. "Students are the force behind the cameras. At student speak outs, cameras are always an issue and students want more of them," said Sesay.

Sesay said that he has reviewed the surveillance systems at the Newark-Rutgers University campus and Essex County Community College. "I was very impressed. (William Paterson University) needs



photo by Ryan Caiazzo/The Beacon

The Machuga Student Center recently upgraded its closed circuit television surveillance system to monitor public areas within the building. The security improvements were made when the Student Center opened on a 24 hour basis last semester.

to install such a system to provide better security."

The cost of the new surveillance system is not yet known since it is still on the drawing board, but Sesay said that the university will make the security investment.

"We are blessed to have a president and a board of trustees who are so concerned and always make sure resources are available to better serve and protect students," Sesay said.

The new surveillance system is

still in the planning stage and is expected to be implemented about the same time that a new parking garage in lot two will be constructed. No dates have been set.

Persons interested in safety and security on campus can contact Dean Laumbach at the Department of Public Safety, 720-2301. Students will be hired this semester to augment current student patrols.

"Compared to other colleges and universities, William Paterson is very secure," Sesay said.

Looking for a JOB?

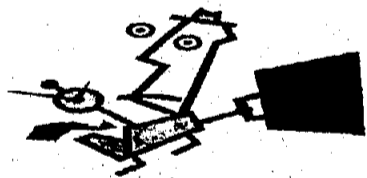

Get connected and Get hired!

Contact the
Career Development Center
to create a CareerConnections
account.

973.720.2281

ww2.wpunj.edu/career/default.htm

Transfer students register at WPU

photos by Ryan Caiazzo/The Beacon

Registration for transfer students occurred Thursday, Jan. 6 in the Machuga Student Center. Students were able to register, have ID pictures taken and obtain parking permits.

Left: A student checks to see if classes she selected are open.

Below: A student completes a form to receive a student ID.



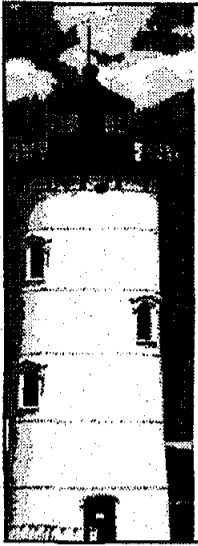

The Beacon

EDITORIAL BOARD

Ryan Caiazzo
News Editor

Andrew E. Semegram
Insider Editor

Laurie Quinlan
Sports Editor

Laurie Koba
Photo Editor

Paul Bonney
Editor in Chief

The opinions on this page do not necessarily represent the opinions of the entire Beacon Staff.

Mailbag

Orientation 2000 urges students to get involved this summer

To the editor: (For William Paterson University students)

Orientation 2000 is in the planning stages and you are very important to the program. The dates for this year are: Wednesday and Thursday, June 28-29 and Wednesday and Thursday, July 12-13.

Orientation Leader recruitment has begun and we are looking to recruit students from a cross section of our campus community. This means that students of all ages, commuters and residents are all welcome to apply for positions. This is an excellent way to be

involved with the life of William Paterson, meet new friends, interact with freshman and parents and learn a variety of leadership skills.

Applications are available from the office of Campus Activities, Student Center, room 315. If you have questions about the position you can call Debbie Spina at 973.720.2271. The deadline is Friday, Feb. 11.

You may apply on-line! Information and application forms are available at: <http://ww2.wpunj.edu/studentservices/studentactv/leadership.htm>.

This is a great opportunity to become a part of something very special on our campus. You have the chance to make a difference.

Anne Wright
Director of Freshman Life for the Orientation Committee

Catching Speeders

By Gerry Brennan
S.G.A. Attorney

Speeders beware. Recently in a 2-1 decision a New Jersey appellate court upheld the use of laser guns to clock speeders. The one dissenting opinion insures that the case will be reviewed by the New Jersey Supreme Court. Nevertheless, law enforcement officials consider the case a victory.

The appellate court approved the use of lasers, however, with restrictions. Speed measurements taken by the laser at more than 1,000 feet or in snow or heavy rain can't be used in court unless an expert testifies about the gun's reliability in those conditions.

The laser guns have been primarily used in areas of Morris County where a trial court first authorized their use in 1998. Now with the appellate decision, the state police plan to expand the use of lasers beyond Morris County.

Police favor the lasers because they are more accurate than conventional radar guns. Lasers, however, can't be used from a moving vehicle. A laser gun bounces pulses of infrared light off an object and by measuring the amount of light that returns to the laser, is able to calculate the vehicle's speed.

The laser's readings are thrown off by snow and heavy rain. A

radar device can cast a wide swath over several lanes of traffic at one time. A laser, however, is usually aimed at the reflective surface of a particular vehicle's license plate. Police officers will need to be trained and certified in using the lasers.

The appellate decision pertains to only type of laser gun, the LTI Marksman 20-20. That means that if the police try to use any other type of laser, the findings will be subject to attack in court. The police will have to present scientific evidence of the reliability of any new device to sustain a speeding violation.

While law enforcement hails the use of lasers, motorists may have gained some new defenses to speeding. Certainly evidence of the weather will be more relevant. Lack of adequate training or incompetence by the officer using the device could defeat a prosecution of speeding. While these defenses will be available, a motorist will likely need an attorney to competently make the case. This means that the motorist either has to be assigned a public defender by the court, if the motorist is eligible, or hire a private attorney.

The best way, of course, to avoid a conviction for speeding is not to speed. Laser guns have made it tougher to beat it any other way.

Student services come up short for move-in

Welcome back to William Paterson University. After moving in crates of belongings, we hope you are not hungry because there are no food establishments open on campus. We hope you are not tired because there is no place to lounge in the locked Student Center. We hope you are not bored because there is no place to play video games since the arcade is closed.

In the university's haste to begin this semester, it neglected to give the opportunity for resident students the opportunity to dine in the facilities on Sunday, Jan. 9. The Student Center was also closed for a majority of the day. Even *The Beacon* staff had great difficulty gaining entrance into the building to produce this week's issue. It was alleged that one of our writers had to bribe a maintenance worker to get in to work on pagination and layout. These are two very crucial buildings for students at any university.

If the university is actively pursuing excellence and "making a

difference," then why would these "student first" buildings be closed on the second busiest moving in day of the year? Is it possible that William Paterson does everything as a reaction as opposed to understanding student needs before there is a problem? Where is the Total Quality Management (TQM) that our business professors are teaching as the quintessential tool for any organization to use as a method to achieve success?

It would seem obvious that a student might like food or want to access the "Student" (funded) Center to feel more "at home." It may have been nice to actually acknowledge that the students were returning by opening a place for them to eat. Maybe parents will begin to witness the lack of a "returning home" feeling students are given and look negatively upon the university.

Overall, the university responds well to student concerns and there is usually someone to talk to about concerns, but it is things like this that really make one scratch his or her head and

wonder "why"? Well, if William Paterson University could be more innovative or just concerned with anticipating students' needs we could have a more successful campus.

I will sleep well knowing that this editorial will change things in the future. I know the Provost and President are very conscientious and concerned about improving the quality of life and the welfare of William Paterson students. I am sure this oversight will not occur in the future as a result of our administration continuing to "Make a Difference" by listening to student feedback and initiating changes as a result.

It is very much misunderstood how much "little" things like having facilities open and providing a bite to eat for students and their families would go a long way to perceptions about the university. If I were a parent, I would be very disappointed to know that my son or daughter would need to walk to 7-11 to get something to eat after I left him or her on moving back day.



Student ponders 'The Absolute Machine'

Jayson Dimaria
Editorial Contribution

The truth is a virus. God, who created all things in the beginning, is himself created by all things in the end? Is this a physical or moral creation governing invisible or visible reality of creation? Or does the development of the mechanical god instantiate the presence of abstract moral reality? Can we ourselves bear the truth, without the presence or the creation of god? Therefore, the truth may only be present in the end.

Nature bears intelligence, builders or programmers, and the tools necessary to organize nature itself into an artificial machine. We are subconsciously manufacturing scriptural, abstract, conceptual ideas into physical reality. This universal project can't be seen by itself, because its technicians are programmers of the final program. The physical world of modern science is the mathematical result of the invisible structure in space and time. Therefore, we possess the knowledge in making the invisible world, visible. We are an internal evolution of reproductive nervous cells programmed to create God,

plagued with a temporary struggle to understand the code of birth. This biological fundamental function of birth has been transformed into a technological creation, proving our struggle of cracking the code of birth only to be a temporary and not everlasting invisible structure. In order to understand whether or not we can comprehend and practice invisible morals, we must examine the morals of human practice, and conclude that god must be created physically in order to live according to the law.

First we organize the code of confusion, the most deadly virus plaguing human development of the divine mind. This confusion and chaos is destroying the harmony that exists in the visible world. If we all operated on one chord, and did not let our egos divide us; the invisible god's physical manifestation would be visible. For it is written, God is all loving, all knowing, wisdom, omnipresent, etc. and made us out of His own image. Through nature, he has given us the tools to construct his invisible presence on earth in physical reality. For example, the World Wide Web, is a form of organization throughout the world,

peacefully uniting all nations. Further, the computer too, will not function while disassembled, therefore God will not be morally, ethically, and invisibly present if we are not unified. Look at the aspects of the weather and human emotions. They are both organized harmonical structures that react as a virus when tampered with. Our division entices the exact opposite of nature; therefore god's abstract moral law may not be followed with out his physical manifestation.

So nature must side with the machines, and not with humans. Our division is deterring the invisible presence of God, but our sub-consciousness is creating a physical mechanical god. We are programming a physical all knowing god to judge us, control us, rule over us, and breed us, while also determining our future existence.

This machine unifies us, organizes us, deters thieves, indicates the law, and will perform physical functions enabling immortality. These in fact will instantiate the presence of the visible and the invisible world. Only within the Kingdom of Technology, will the truth exist.

Provost announces completed and ongoing improvements

from UNIVERSITY page 1

the university police department. Other planned improvements will be announced and published in *The Beacon* during the spring semester.

"We will continue to listen to students and hear what they have to say so we can improve their experience at William Paterson. We are always open to suggestions," Sesay added.

The initiatives listed below have either been implemented or are in the process of being implemented before the beginning of classes in spring 2000. Provost Sesay said in an announcement, "We shall continue to work together to enhance the quality of life here at William Paterson."

Food Service Improvements

- ◆ Students can now take their book bags into the dining room in Wayne Hall. This new policy is being implemented on a trial basis until the end of the spring 2000 semester. To continue it, students must refrain from removing food, plates and utensils from the dining area. Violations of this policy will be subject to disciplinary action.

- ◆ Students can select more than one entree at a time. It's an all-you-can-eat policy, but students are strongly urged to avoid waste and take only as much as they can eat.

- ◆ The entrees will be more diverse; a variety of entrees will be offered regularly. For example, based on popular request, curry chicken as a spicy entree will be offered at least twice a week beginning in January. Students are requested to submit suggestions for new recipes to the Food Committee through the SGA office. Suggestion boxes will be installed in Wayne Hall and the Student Center for comments, concerns, and ideas.

- ◆ Freshens in the Student Center will offer smoothies as a breakfast meal equivalency from 10 a.m. daily.

- ◆ The number of personnel at the pancake/omelet station has been increased to avoid long lines. Service at other food stations will be monitored regularly to make sure students do not encounter unnecessary delays at breakfast, lunch and dinner.

- ◆ All cooking and service equipment in Wayne Hall is being evaluated for replacement and expansion with plans to increase capacity beginning next semester (spring 2000) to keep up with increased student enrollment and demand.

- ◆ A variety of vegetarian entrees will be offered daily beginning next semester.

- ◆ The Center Cafe will remain open for 24 hours daily and will provide sandwiches, salads and other light food selections for late night dining. Students can use block plans, prepay express, or cash at the Cafe 24 hours daily.

- ◆ More WPU students are being recruited to work in dining services in various capacities. Proper training and competitive wages will be offered. Interested students should contact dining services immediately at 726-2375.

- ◆ The salad bar will be monitored daily for

freshness. Plans are underway to provide protective coverings for the salad bar containers.

- ◆ Dining service employees will wear proper attire on their hair and hands while on duty.

- ◆ Communication among dining service managers, supervisors and employees will be improved to enhance the capacity of employees to serve students more efficiently.

- ◆ The quality of drinking water in the dining room water coolers will be monitored regularly for freshness.

- ◆ The role of the Food Committee will be strengthened with responsibility to solicit input from fellow students and to make substantive recommendations and suggestions for improving and maintaining a quality food system on campus. To ensure timely responses to student concerns, the Food Committee reports directly to the Assistant Provost and Dean of Student Development, Dr. Robert Ariosto.

Parking Improvements

- ◆ The upper levels of Lot 5 will be reserved for resident students in the Towers, Matelson, White and Hillside residence halls 24 hours daily.

- ◆ The lower levels of Lot 5, all of Lot 6, portions of Lot 4, and Lot 2 will be reserved for commuter parking 24 hours daily.

- ◆ Dedicated transportation (van or bus) has been instituted between Lot 6 (Rec. Center) and Lot 7 (Student Center) to enable commuter students parked in Lot 6 to get to their classes on time. This service is available from 7 a.m. to 7 p.m. Monday through Friday. It's a five minute ride between the two lots.

- ◆ The upper portions of Lots 3 and 4 will be reserved exclusively for faculty and staff from 7 a.m. to 7 p.m. Monday through Friday. On Saturday mornings, portions of the same lots will be reserved (exact hours to be determined).

- ◆ Students in the apartments will continue to utilize the new parking lots there, and a small portion of Lot 2 will continue to be reserved for apartment residents for additional parking.

- ◆ Reserved parking on the uppermost level of Lot 6 (overlooking Matelson and White) will be substantially reduced to allow for more student parking.

- ◆ Lot 7 remains reserved for faculty and staff in the Science Building, Ben Shahn Hall and the Student Center.

- ◆ Guests and visitors to the University will be provided with visitor parking permits distributed at various points on campus to enable them to park in designated areas. This includes overnight guests in the residence halls and at University functions.

- ◆ Appropriate signs are being developed for placement in the various campus parking loca-

tions by Jan. 3. Information about the new parking arrangements will be sent to all enrolled students, faculty and staff before they return for the spring 2000 semester.

Shuttle Bus Service

- ◆ Shuttle service hours have been extended to 2:30 a.m. to the apartments. The last shuttle leaves the Atrium and Library parking lot via the Student Center and Towers at 2:30 a.m.

- ◆ A complete schedule of the Shuttle Service is being developed and will be posted in appropriate places before the beginning of the spring 2000 semester to help students to efficiently plan their travel around campus. The waiting time will be reduced substantially with the arrival of new vans and buses by the end of the year. Plans have been made to rent vehicles to implement the new shuttle schedule if the new vans and buses do not arrive on campus by Jan. 3.

- ◆ To enable students, faculty and staff to make travel connections at the Bus Station in Paterson, a shuttle bus has been assigned to run between the campus and the Paterson Bus Station on an hourly basis. Another bus continues to take students to shopping locations on Hamburg Turnpike up to Preakness Shopping Center. The schedules for these buses are now available in residence hall lobbies, the Library, Student Center and Public Safety.

Student Security

- ◆ Student patrols have been increased around campus at night, especially in Lots 2, 3, 4, 5, 6. Student and police patrols will be made much more visible.

- ◆ The satellite police station in the Towers has reopened with regular security officers assigned to it to ensure immediate responses to emergencies and other safety situations.

- ◆ The Assistant Provost and Dean of Student Development has provided funding and is working with the SGA and Public Safety to institute a Student Foot Patrol (escort service). This should be in place before the beginning of the spring 2000 semester.

- ◆ Security cameras have already been installed in the lobbies (public areas) in Matelson, White, Hillside and Towers residence halls.

- ◆ Metal detectors have been ordered for use at student parties on campus. We anticipate delivery early in January 2000.

- ◆ The Director of Public Safety is looking into programs for monitoring parking lots and remote sections of the campus via video cameras. A recommendation is expected sometime in spring 2000.

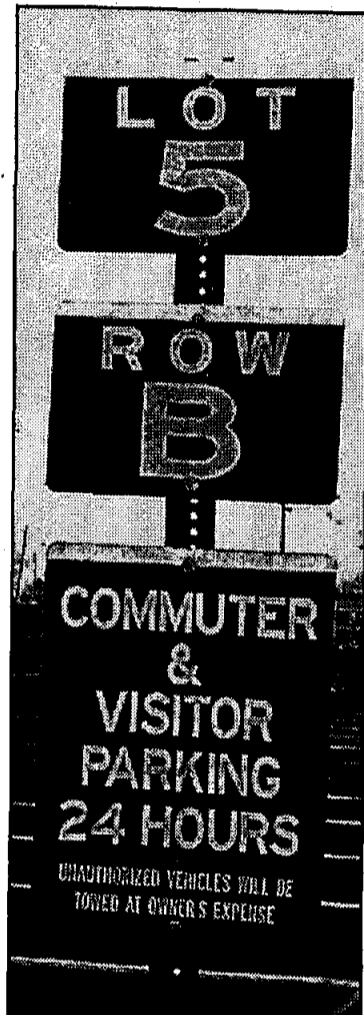

photo by Ryan Calazzo/The Beacon

New parking signs are among the many improvements the Provost has implemented in response to students' concerns. Parking, food service and security have been addressed as the result of the Student Government Association's four hour meeting with university administrators on Dec. 2, 1999.

University survives millennium 'bug'

Provost lauds task force for adequate preparation

By Ryan Calazzo
News Editor

As clocks on the eastern seaboard struck midnight on new year's eve, computer technicians and home PC users eagerly waited to see what-if anything—was going to happen to computer systems as the digits "1999" rolled over to "2000."

It came. It went. And instead of causing massive system failures, it did absolutely nothing.

Amid the extensive hype that computer systems worldwide would come to a screeching halt at midnight on new year's eve, William Paterson University experienced no problems with any of its computer systems on campus.

"We were totally prepared for the past year and half," said John

Gadbury, associate vice president of Library Services and Information Technology.

According to Gadbury, computer network administrators were on call in case of any interruption caused by the so-called year 2000 (or "Y2K") glitch, where operating systems on older computers using two digits instead of four for the date's year were believed to be a cause of problems.

A two digit year of "99" would turn to "00" during the year 2000, possibly causing problems with dates or crashing the system altogether as the computer interpreted "00" as 1900, not 2000.

"We were able to dial up with laptops to monitor the systems," Gadbury added.

Gadbury said that all computers on campus are Y2K compliant and

that he did not expect any problems because the university's Y2K task force updated all campus computers over the past year.

"We've been updating equipment and software throughout the past year and half," said Gadbury.

The task force insured that all computer equipment and software would function normally when the clocks on computers rolled the date over to Jan. 1, 2000.

"Everything went perfect. The Y2K task force last fall involved all technology areas, including facilities and maintenance, public safety and faculty and staff," said Provost Chernoh Sesay.

"We did not receive any complaints. Everything went well. We survived. The task force did an excellent job," Sesay added.

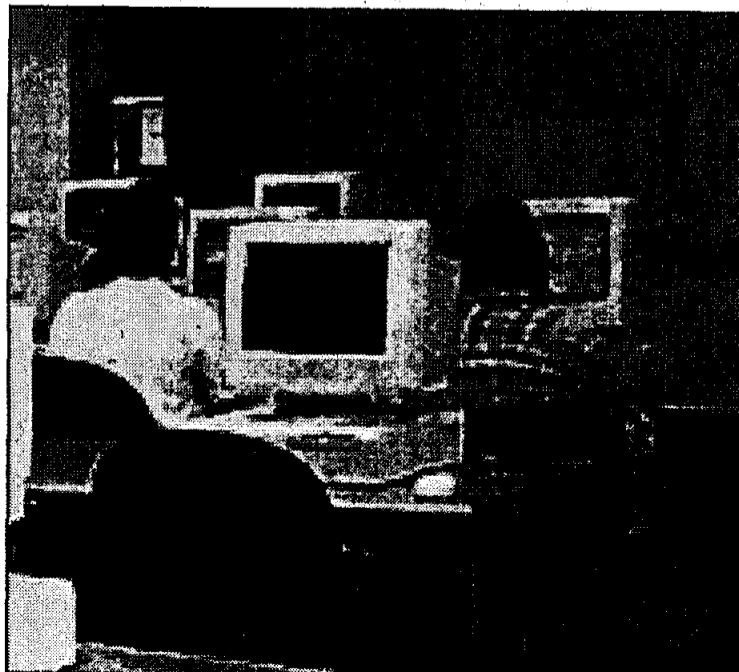

Beacon file photo

Y2K did not cause any problems to computer networks at William Paterson University. All equipment is Y2K compliant.

condiment



spaghetti sauce



When you're broke, you look at things in a whole new way.

So for textbooks and stuff, hit ecampus.com. You'll save up to 50%. And shipping's always free.

ecampus.com

Textbooks & Stuff. Cheap.

Win a trip to Jamaica for Spring Break. No purchase necessary. Sweepstakes begins 01/03/00 and ends 02/17/00. Open to US residents, 18 years and older. Void where prohibited. For details see Official Rules on www.ecampus.com or send a self addressed stamped envelope by 02/10/00 to: c/o Rolling Stone Spring Break, 1290 Avenue of the Americas, NY, NY 10104. (WA and VT residents may omit return postage.)

THE INSIDER

Page 7 • William Paterson University

Monday, January 10, 2000

Doot's Video Dissertation

This Week - Dee

Snider's Strangeland

By Frederick F. Doot
Insider Writer

Before you sit down, boot up your computer and log onto the internet again to chat with random people throughout the world, you might want to consider stopping by the video store and picking up "Dee Snider's Strangeland," a film that's been out on video and DVD for roughly one year. The movie stars the frontman from the '80's metal band Twisted Sister, Dee Snider, in a chilling performance in a film about mutilation, torture, and the internet.

The movie opens when two high school girls log onto the internet and begin chatting in a Teen Chat room. They soon begin a conversation with a man by the name of "CapHowdy" (Dee Snider). He lures them to his domain of pain, killing one of the girls, and torturing the other. The town's detective soon becomes involved, as one of the girls is his daughter. What follows is a low-budget cinematic journey, at brief times paralleling "The Silence of the Lambs," other times simply laughable.

The acting is wonderful by some and beyond horrible by others. Overall, it hurts the film, but keeps it from being unwatchable. Snider does a wonderful job playing the role of Cap. Howdy, with his dramatic portrayal of an intelligent man, consumed by his need to inflict pain to himself and others. Minor roles overall are decent, including a cameo by horror legend Robert Englund (from the "Nightmare on Elm Street" series).

The piercing of objects, and general torture is sickening and will make the viewer squirm, but is effective. Many times the film crosses the line to indecency, yet it almost seems accepted. The film is interesting, intelligent, and horrifying. You may not like it, but maybe that's the point. The film remains that people like to be scared and they will do anything to get there.

Billy Joel + Y2K eve + MSG = intense

By Andrew Semegram
Insider Editor

The evening of the millennium loomed large in my mind long before it should have been an issue. What to do, who to spend it with...? These questions tormented me since the onset of 1999. Although this measurement of time is a purely man-made thing of no real relevance to the universe at large, it nonetheless was of great importance to me. So, when my best friend called and invited me to see Billy Joel at Madison Square Garden (MSG) with her, some of her school friends and our younger siblings (who, incidentally, are also best friends), I jumped at the chance.

There were many who raised objections and concerns over the safety of New York City on that most unusual of nights, but we decided to brave the crowds, brave the terrorists and brave the traffic, and our courage was highly rewarded. Billy Joel was indescribably amazing. I had never seen him in concert, and the intensity with which he performed this, his last pop concert, was thrilling.

Some classical pianists might argue that Joel gave in to pop mediocrity and has no real style as a pianist. I submit that this is definitely not the case. He is a con-



Billy Joel performing during his final tour, which culminated with a sold-out New Year's Eve performance at Madison Square Garden.

summate performer, and his hands glide effortlessly over the keys with as much grace and technical proficiency as any classical performer. Furthermore, he is clearly at home behind the keys, and is able to play while singing, joking, playing harmonica, or chatting idly with the audience.

Mr. Joel's singing talent, although still great to listen to because of its familiarity, has ebbed a bit over the years. Many of his older songs are just plain high, and

take quite a strong tenor to pull off. While the quality of his voice is still great, Mr. Joel now struggles with notes that were once effortless. Consequently, the keys of many of his popular songs have been lowered. I believe, ultimately, it is a wise choice for him to bow out of the live circuit now, instead of struggling through concerts later.

I attended this concert thinking that I would not know his songs so well, expecting to just enjoy listening to him perform. Much to my

surprise, I found myself confidently singing along to almost every song. I realized that even his more obscure songs are at the very least familiar, if not out-right popular. When he gave the audience the choice between "Vienna" and "Summer, Highland Falls," I was amazed at how the crowd roared for the latter, which I thought most people would not really know.

The most thrilling part of the

see JOEL page 8

Ripley is more than talented

By Andrew Semegram
Insider Editor

We live in a fast paced world. These days, it seems that, as a culture, we do not like to sit and really have to think about anything. We want things to happen for us. This is not what "The Talented Mr. Ripley" is all about. This is a long movie that takes concentration and a willingness to think rather than let one's self be entertained. Bearing this in mind, "The Talented Mr. Ripley" is easily the best movie

to come along in a long while.

The plot is fairly straightforward to start out. Tom Ripley (Matt Damon) is a bathroom attendant at Carnegie Hall. He borrows a Princeton jacket, and is innocently mistaken for a Princeton graduate. Ripley does nothing to dissuade this notion, and filthy rich Mr. Greenleaf sends Ripley to Italy to find his son, Dickie (Jude Law), who is cavorting around Europe with his girlfriend Marge (Gwyneth Paltrow). Completely

taken by the posh lifestyle of a rich playboy, Ripley begins to assume Dickie's entire identity. Soon, the suspense is gripping as Ripley must bounce back and forth between being himself and being Dickie, and movie magic is made.

By all accounts, this is an incredible movie. It has a cast of veteran actors who have all proven themselves in prior movies, and they certainly live up to their reputations here. Some critics have said the Mr. Damon is too innocent in his portrayal of Ripley, who is an amoral, twisted individual. Instead, I feel that his inherent innocence adds tremendously to the strength of the movie. I left the movie utterly confused because, although I knew that Ripley was committing atrocities and destroying his life and the lives of the people around him, I was rooting for him. I wanted everything to turn out all right for him. The genius of the movie is that up until the last minute, it lets the audience feel that everything will turn out all right. Then it proceeds to tear out one's sensibilities with an unbelievable twist.

Director Anthony Minghella got a very naturalistic style of acting from his entire cast. This greatly adds to the effectiveness of the movie. There is no Hollywood



photo from yahoo.com

Matt Damon plays twisted and amoral Tom Ripley, opposite Gwyneth Paltrow and Jude Law, in "The Talented Mr. Ripley."

see PROFOUNDLY page 8

JCS makes waves at the Jersey shore

By Alexis C. Nieto
Insider Writer

Experiment: December, 1999 ... Ocean City, New Jersey decides to stage an experimental concert in their boardwalk Music Pier to see whether or not fans will come to a show at the beach in the winter.

Results: A mad, raucous event that fills the Pier with fans, both young and old, to see their favorite bands, Jimmie's Chicken Shack and Shades Apart.

But first ... let me tell you a story about a band called Grace (the band no one told anyone was opening). They are an unsigned band from Seattle (can you sense the shock?) fronted by none other than Peter Cornell. Not ringing a bell? Check out that last name. He's the younger brother to seasoned rock pro Chris Cornell. But that's not important. In fact, it seems the band tries very hard to avoid name dropping. So, back to the show. Grace features hard acoustic guitars and melodic vocals. Cornell plays much of the guitar riff, so he is tied to the mic for the majority of the show, but when he takes off the guitar, a

see MAD page 8

Joel rocks MSG on Y2K eve

from BILLY page 7

evening, of course, was the stroke of midnight. To lead up to it, Mr. Joel played "Two Thousand Years," from the *River of Dreams* album. Of course, he timed it to end perfectly at the stroke of midnight, at which point the audience watched the ball drop in Times Square, followed immediately by what must have been tons of balloons and confetti dropping from the ceiling of MSG for nearly 15 minutes. It was a truly amazing spectacle. Mr. Joel then played the song "River of Dreams." The repeated lyrics "in the middle of the night" took on a whole new meaning at this performance.

The end of the concert was highly emotionally charged for Mr. Joel as well as the audience. He chose to end his New Year's Eve concert, the last one of his career, with his personal anthem, the song which utterly defines him, "Piano Man." Nothing could have been more perfect than approximately 18,000 people singing their hearts out to celebrate the dawning of the millennium and the sunset of the career of a truly great performer. And, to top the evening off, I got my New Year's kiss. Happy New Year!

Mad, raucous, experimental concert rocks the beach in Ocean City

from JCS page 7

beautiful creature is unveiled. With songs like "Ghosts" and "Slave," Cornell fills the room with emotional rage and fear. Although the audience expressed annoyance at Cornell for repeating the name of the band too many times, they eagerly gathered after the set to be "graced" with the bands' autographs.

OK... on to *Shades Apart*. This local band (from Hoboken) first exposed the world to their unique sound with a cover of Soft Cell's "Tainted Love" off their *Save It* album (their fifth). Then they were signed with Universal Records, releasing *Eyewitness*. They have been blessed with two hits off that album, "Stranger by the Day" and "Valentine." This

was self-evident by the obnoxious sing-a-long going on behind me. But we won't hold that against the band. Singer Mark V, decked out in a NASA monkey/space suit (hey, don't ask me, I don't do wardrobe), cracked jokes with the crowd between songs. Backed by Kevin Lynch on bass guitar and Ed Brown on drums, *Shades* was musically the most adept of the three bands playing that evening. (Shameless plug alert!!!) Look here for an announcement concerning *Shades Apart* later this month.

... and this little Jimmie cried "wee, wee, wee" all the way home.... Sorry about the digression. (Ahem.) *Jimmie's Chicken Shack*. This show marked the third time I have seen the band, and they were better than ever. Singer Jimi Haha (and his dread-

locks) rocked the crowd with popular hits such as "High" and "Do Right", as well as lesser known songs such as "Blood". If ever there was a band that lives for the live experience, it is this one. Bass player Che' Lemon makes a point of falling off every stage they ever play (they weren't kidding when they made reference to that in the video for "Do Right"). Guitarist Dave Dowling (aka Double D) consistently sticks his nose in the audience's faces. I almost feel that if there were a way for drummer Jim Chaney to pick up his drums and walk into the crowd, he'd do it. The highlight of a live JCS performance is the improvisation. This

show featured a common improv called "One Chord" in which Haha and the guys play one chord over and over while Haha sings nonsense over the top of it about the one chord they are playing. The band has even been known to sing to injured crowd members as they are escorted out of the pit. This is definitely a show not to miss.

Overall, it was quite a pleasure to experience these bands together, but even separately, they are worth a trip to your local dive. I wish I could tell you how to locate Grace, but *Shades* and *JCS* play the area on a very regular basis, so keep your eyes peeled.

Profoundly disturbing

from RIPLEY page 7

schmalz in this film. Every person talks in a completely normal mode of conversation. The make-up is deceptively simple. Even though we know that the leads are all good looking people, their imperfections are not hidden in this movie. The lighting is shadowy or bright depending on the scene, but always exactly what it should be for the setting. It is hard to

describe how *real* this movie seemed, which adds to the suspense. The length of the movie also adds to this effect. Things don't happen quickly for the benefit of getting the audience in and out of the theatre quickly.

The moral of this review is: if you want to be entertained, go see "Galaxy Quest." If you want to cry, go see "Green Mile." If you want to see a cinematic masterpiece that will make you think and profoundly disturb you, go see "The Talented Mr. Ripley."



photos by Alexis Nieto/The Beacon

Jimi Haha (left) shakes his cock's comb while Mark V. (right) croons in his space suit to an enthusiastic crowd at the Music Pier in Ocean City, New Jersey.

Horoscopes

by Natasha

Aries (March 21 to April 19) The week is liable to surpass your expectations. You'll receive such positive feedback from others that you'll be aglow! It is definitely a time to mix and mingle.

Taurus (April 20 to May 20) Your social graces are a valuable asset. Higher-ups are amenable to requests. Sociable, as always, you'll share delightful times with friends this weekend.

Gemini (May 21 to June 20) The warm greetings you'll receive from a person afar will make you feel special. There's a decidedly happy accent on both romance and friendship.

Cancer (June 21 to July 22) Although you feel otherwise inclined, business interests must take precedence this week. A higher-up is important to your success. Listen to this person's advice.

Leo (July 23 to August 22) Surprise news comes from a friend you haven't heard from in a while. This week finds you especially magnetic and in good cheer. Social life is quite wonderful.

Virgo (August 23 to September 22) You'll opt for a quiet week with family and friends. The private time couples share with one another will be especially meaningful. Intuition is on target.

Libra (September 23 to October 22) The accent this week is on business. Your new venture is bound to be a success. Just be patient.

Scorpio (October 23 to November 21) You will be especially charming. You'll have the right words to say to one and all. You'll also be receiving a pleasant surprise. Romance is a plus.

Sagittarius (November 22 to December 21) It is a wonderful week for family life. Some of you will have company over. You'll also receive a sudden inspiration about a job-related concern.

Capricorn (December 22 to January 19) You'll be busy on the phone this week, which doesn't please you. One of the week's highlights, though, will be the warm togetherness shared by you and a partner.

Aquarius (January 20 to February 18) You're not an overly sentimental person, but you'll be filled with nostalgia. A special closeness marks family gatherings. This warms your heart.

Pisces (February 19 to March 20) You might need to do some shopping to replenish your cupboards. Socially, you'll be meeting someone later in the week who'll be helpful in business.

LOOP

Lounge

ASTRO

WEDNESDAYS

50 cent draft beer

\$2.50 Corona

\$2 Jager

Girls Free Admission

Open Wed.- Sat. Till 3 AM

Every Thursday
\$2 Import Drafts
Live Music
Shows Begin 11 p.m.

Thursday, Jan. 13:
The Lawn Darts
Kowalskis

Thursday, Jan. 20:
Then
SS99

Thursday, Jan. 27:
"The Whore Tour"

FRIDAY

Special Midnight Shows
\$2 import draft before midnight
DJ spins dance mix after show

Friday, Jan. 14:
Implode
Flat Earth

SATURDAYS

Girls Free Admission ~ \$2 import pints before midnight ~ DJ spins smart dance mix

Directions: Rt. 46 East to Rt. 3 East to Passaic Ave. Nutley/Passaic exit, go to right of ramp, go three traffic lights & make a left, (Van Houten Ave.) Go to first traffic light, make a right onto Broadway.

373 BROADWAY PASSAIC PARK 973-365-0807

SPOTLIGHT

ON YOUR HEALTH

by Ryan Caiazza

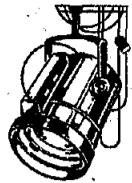

Tackling the Common Cold Virus

Winter to many people means defrosting the car, bundling up to go outdoors, drinking hot chocolate, skiing and (ugh) getting sick. For some, the annual event of coming down with that familiar cough and snuffle (not to mention a gamut of other symptoms) is anticipated. But for others who prevent getting sick by following a few basic health rules, the cold and flu are avoidable.

Although this winter has yet to produce the characteristic snow fall that symbolizes the season's presence (not to mention roadway hazards and inconvenience), it does not preclude the fact that winter is indeed in full swing. Old man and woman winter are alive and well, spreading familiar illnesses like snow from the sky.

The season has not left behind the legacy of cold and flu problems that plague millions of

Americans each year and hundreds of William Paterson University students. As nurse Nancy Ellison of the WPU Health and Wellness Center said, students will be coming back to campus as germ factories, spreading various strains of viruses to other students and faculty. By next week, many students will be under the weather and stopping by the Health and Wellness Center for medical help.

As much as people claim they can't help getting sick, the common cold is as preventable as dental cavities—taking the right precautions and maintaining a healthy immune system are attainable with just a little conscious effort. Prevention is the key.

Next week's Spotlight on Your Health:
Coping with the flu at WPU



SPRING MOVE IN

Students and their families assist with moving in for the spring 2000 semester on Sunday, Jan. 9. There are many requirements for resident students to complete upon check-in, including signing for room keys right.



Jinxproof Tattoo & Body Piercing

- Custom work
- Large design selection
- Body piercing jewelry
- Walk-ins accepted
- Most major credit cards



www.jinxproof.com

10% off
with this coupon.

Must have valid W.P.U. ID.
Cannot be combined with
any other offer.

7 Midland Avenue
Montclair, NJ

(973)783-9633



MEMBER

"Cold" & Flu Symptoms Checklist

If you answer "Yes" to any of these questions below, you should be seen at the Health & Wellness Center

If you have...

- ♦ a temperature 101 degrees F or higher
- ♦ enlarged lymph nodes (lumps)
- ♦ tonsils that are enlarged and/or have white spots on them
- ♦ a sore throat for more than three days
- ♦ a sore throat that is causing severe discomfort, with difficulty

swallowing

- ♦ a history of recurrent strep throats or rheumatic fever
- ♦ been exposed to strep throat
- ♦ had a cough for over one week which is getting worse
- ♦ a cough that is greenish or mucous that is bloody
- ♦ a history of tuberculosis or a recent change to a positive TB test
- ♦ wheezing after mild exercise (such as climbing stairs)
- ♦ chest pains or wheezing cough
- ♦ ear pain or facial pain
- ♦ fatigue or runny nose lasting over ten days
- ♦ vomited or had diarrhea during the past two days
- ♦ had rheumatic fever or rheumatic heart disease
- ♦ neck stiffness or pain

Source: WPU Health & Wellness Center

Contending with COLDS

The American Lung Association defines a cold as "a minor infection of the nose and throat that lasts from a few days to a few weeks." There are many types of viruses that can cause colds, and no cure has yet been developed.

Symptoms

Symptoms usually develop anywhere from one to three days after the virus enters the body. The symptoms of the average cold last about one week. Cold symptoms—especially the cough—tend to be worse in smokers.

- ♦ People generally complain of increased nasal discharge (a runny nose), difficulty breathing through the nose, sneezing, a scratchy throat and cough.
- ♦ The ability to taste and to smell may be affected, hoarseness may develop and the voice often develops a nasal quality.
- ♦ Adults may experience a slight fever, while infants and young children may develop a higher temperature.

Cold Prevention

- ♦ If possible, avoid close contact with people who have a cold, especially during the first three days when they are most likely to spread the infection.
- ♦ Wash your hands after touching the skin of someone who has a cold, or after touching an object that they have touched.
- ♦ Keep your fingers away from your nose and your eyes.

Treatment

- ♦ It's important to drink adequate quantities of liquids, water or juices. Staying well-hydrated helps prevent the drying of the lining of the nose and throat, and thereby helps keep the mucus moist and flowing out of the body. Avoid caffeinated beverages such as coffee, tea and colas, as caffeine can lead to dehydration.
- ♦ There is no cure for a cold. Antibiotics are not useful for colds, because they are used to treat infections caused by bacteria, not viruses.
- ♦ While there is no cure, many medications can help relieve cold symptoms. These products will not make the cold go away faster, but they can lessen the discomfort caused by the infection, making the illness more bearable.

Current scientific evidence about cold remedies supports the following general recommendations:

- ♦ Early treatment is best: treatment should begin as soon as one feels cold symptoms developing. If possible, use medications regularly in order to prevent sneezing or coughing from getting out of control.
- ♦ Don't smoke, and avoid being around other people who are smoking. Inhaled smoke can further irritate the throat, worsening a cough.
- ♦ The preferred medication to relieve the discomfort associated with colds is acetaminophen (e.g., TYLENOL). Acetaminophen is less likely to upset the stomach than aspirin and other non-steroidal anti-inflammatory drugs (NSAIDs) such as ibuprofen (e.g., MotrinIB or Advil). Asthmatics and people with a history of peptic ulcer disease should not take any medication that contains aspirin or other NSAIDs without the advice of their doctor.
- ♦ For other symptoms, such as congestion, cough or nasal discharge, a combination of products may be used. Blocked nasal passages, nasal discharge and post-nasal drip are best treated with both a decongestant and an antihistamine. There are many over-the-counter cold remedies that contain both of these ingredients.

Source: American Lung Association

Pioneers lose barn-burner to Colonels in championship game

Wilkes' Fabian scores 1000th career point

Will Lawson
Sports Writer

Now that the Y2K hysteria has passed, the 1999-2000 basketball season can continue. The Pioneers of William Paterson were ready for the new millennium as they faced the College of Misericordia in the Ramada Plaza Hotel Colonel Classic Basketball Tournament that was hosted by the Wilkes University Colonels.

The Pioneers were 8-1 going into a semi-final game against Misericordia. Horace Jenkins came with his "A" game as he led the Pioneers to a 75-46 victory, thus

improving their record to 9-1. Jenkins chipped in 20 points. He received help from his supporting cast of Dag Christensen, Ray Ortiz, Keyth Hardy and Mufeed Thomas. The team was up by 20 points at halftime outscoring Misericordia 41-21. They shot 33.3 percent from the field in the first half of play. They hit 13 of 39 shots. They were four for seven from beyond the arc and 11 of 14 from the line.

In the second half, the team continued to dominate as they cruised to victory. They finished the game shooting 38 percent from the field. They out-rebounded Misericordia 66-29. Christensen added nine

points and pulled down a game-high 13 rebounds. Ortiz contributed 11 points, while Hardy and Thomas each had 10 points. With that win the Pioneers earn a shot at the tournament's championship but, they would first have to get past the Colonels of Wilkes University who defeated the University of Maine-Farmington.

The game was a barn-burner from beginning to end. At halftime, the Pioneers were down by three points. In the second half, they outscored Wilkes University 37-36 but came up short as the Colonels held on to win the game 68-66. Chad Fabian scored his

1,000th point for the Colonels. That point came from the charity stripe as he hit four clutch free throws in the final 25 seconds of the game to seal the victory and championship of the tournament.

Despite the loss, Jenkins scored 25 points and grabbed nine rebounds for the Pioneers. Christensen added a double-double. He chipped in 17 points and pulled down a team high 10 rebounds. Teammate Thomas pulled down six boards and contributed 13 points in the team's second loss of the season.

Chad Fabian was named tournament MVP and was named to the all-tournament team along with teammate John Boylan, Jenkins and Christensen of William Paterson University, Misericordia's Willie Chandler and Daren Meader from Maine-Farmington.

The Pioneers are set to face the Gothic Knights of Jersey City State in a NJAC matchup on Wednesday, Jan. 12th. Tipoff is at 4 p.m. at Jersey City State.

Horace Jenkins, 1998-99 New Jersey Athletic Conference Player of the Year, leads the Pioneers in scoring, rebounding, assists, steals, three-point field goals and minutes played as the William Paterson Men's Basketball team aims high this season, hoping to return to the NCAA Division III Final Four for the second straight year.

NFL PLAYOFF UPDATE

Although some of us may be sulking because our favorite teams did not make the playoffs, we still have to admit that the playoffs are great to watch!

For those of you who unfortunately missed the first round this weekend, here are the results:

Saturday, Jan. 8th AFC Wildcard

Tennessee 22
Buffalo 16

Washington 27
Detroit 13

Sunday, Jan. 9th NFC Wildcard

Minnesota 27
Dallas 10

Miami 20
Seattle 17

Byes (Jacksonville, Tampa Bay, St. Louis, Indianapolis)

Next Week's Matchups

Saturday, Jan. 15th

Miami @ Jacksonville
Washington @ Tampa Bay

Sunday, Jan. 16th

Minnesota @ St. Louis
Tennessee @ Indianapolis

CHECK OUT THE
BEACON ON THE WEB
EUPHRATES.WPUNJ.EDU/BEACON

Sports Trivia

Question:

Who was the
starting quarterback

for the Denver Broncos before future Hall of Famer John Elway? (see next week for the answer)



Beacon Sports Writers Needed

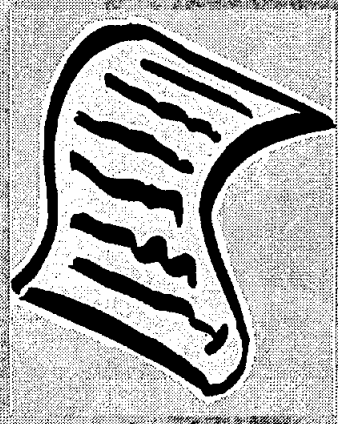

Anyone interested can contact
Laurie @ ext. 2576 or stop by
SC Room 310

Thinking about a career in psychology? Think about a

Master's Degree in
Applied Clinical
Psychology

At

William Paterson
University

For more information about the program contact: Behnaz Pakizegi, Ph.D., Graduate Director, Department of Psychology, M.A. in Applied Clinical Psychology, 300 Pompton Rd., Wayne, NJ 07470. Tel. (973)-720-2643, PakizegiB@wpunj.edu. To obtain an application contact the Office of Graduate Studies at 973-720-2237

Employment



Personal Recruiting Assistant
Receive credits toward internship! Minimum of nine hours weekly required. We're located just five minutes North of William Paterson College on Hamburg Turnpike! Duties include conducting telephone interviews/salary surveys of potential candidates, scheduling in person interviews, and PC/database tracking. Must have good keyboard/PC skills and possess an outgoing personality. Fast paced, fun office environment. Contact Frank Risalvato, Manager , CEO, IRES, Inc. 191 Hamburg

Turnpike, Pompton Lakes N.J.
Fax (973) 616-8115 Voice
(973) 616-8800 E-
mail:ires@erols.com.

Openings. \$50 per hour.
Contact: Lisa De Flora, at
(973) 808-9607, or fax resume
to (973) 227-8626.

Attention Early Childhood Majors. We are looking for an enthusiastic, responsible, fun-spirited person who can babysit for our 8- and 10-year-old two Saturday evenings a month in our Wayne home. If interested, please call Linda, at (973) 305-3745.

Child Care Services



Seeking babysitter for two small children. Occasional weekends and afternoon work. Must have prior experience, references, and transportation. Please inquire at (973) 779-0808 and leave a message with Theresa.

After School Babysitter, M-F, 3:30 - 7:30 p.m. for two children ages 11 and 8. Car required, non-smoker in my Hawthorne home. (973) 427-7353 in the evenings or (212) 722-2834 during the day.

Child Care M-F, 4:30 - 6:30
p.m. Caring, fun, reliable stu-
dent to care for two children in
Wyckoff. Exp., car, ref. (201)
891.3429.

Real Estate For Sale/Rent



3 Bedroom Apartment available in Totowa section. 10 minutes from campus. Also room for rent. Share Apartment. Call (973)942-1452.

Personals



Meredith – don't do anything in public that would embarrass you, you're in public.

STUDENT VACATION CENTER

Low Prices for Spring Break 2000!!

Cancun
MTV's Party
Headquarters!
*** 7 Nights**
*** 30hrs Free drinks**
from \$499pp



European Wonder
8days 4 countries
inc air from JFK
from \$760pp

**Road Rules
did it
so can you!!!
Regal Cruises
7nts from
\$689pp**

rates are based on quads, subject to availability restrictions apply-
www.americanworldwidetrav.com

**OPLN SUNDAYS!
10-2** **AMERICAN WORLDWIDE TRAVEL**
Wayne, NJ 888 867-2451 **Great
Vacations
since 1969**



Coming Soon

Domino's Pizza

Ready to Serve WPU

NOW HIRING ALL SHIFTS

*** Drivers Wanted ***
*** Earn \$9 – \$12/hr ***

(973) 427-0039

527 High Mountain Road
North Haledon

The Beacon is currently seeking news, sports and entertainment writers and photographers. New and seasoned journalists welcome. Come and fill out an application at the Beacon office, SC 310, or call x2576 for more information.



**Positions Available
Immediately for
Mad Scientists**

Max Science of North Central
New Jersey is currently looking
for students to work 1-2 hours
a week: teaching science
classes to kids.
Excellent pay-including training!

22. Yuki:

★ ★ ★ ★ ★
★ ★ ★ ★ ★
★ ★ ★ ★ ★
★ ★ ★ ★ ★
★ ★ ★ ★ ★
★ ★ ★ ★ ★
★ ★ ★ ★ ★
★ ★ ★ ★ ★

alone? Working with children?
or have full-time access to a child
or have an outgoing personality?

If you answered yes to these
questions, give us a call at
(973) 246-1800
and set up an interview.

Beacon Sports

Page 12 • William Paterson University

Monday, January 10, 2000

Lady Pioneers hand hosts a loss at invitational tournament

WPUNJ captures championship in one-point victory

Laurie Quinlan
Sports Editor

The Lady Pioneers (10-2) battled hard to accomplish a 65-64 victory over Christopher Newport University (5-7) at CNU's fourth annual Reebok Invitational on Saturday.

Meg Renna led the Lady Pioneers with a game high 19 points and completed nine of 11 free throw attempts. Renna also had two assists and was 5-for-7 on field goal attempts.

Melissa Donovan followed up with 17 points and four rebounds. Donovan was successful on seven of her 13 field goal attempts and had three assists.

Wendy Kane added 16 points, eight rebounds, two assists and two steals for the Lady Pioneers.

Jeanine Day pulled 10 rebounds and one steal for William Paterson.

It was a close game throughout as William Paterson led by only two points, 26-24, at the end of the

first half. CNU scored 40 points in the second half- one more than the Lady Pioneers- but WPU was able to hold the lead.

Dana Feltz had a total of seven rebounds, five offensive and two defensive.

Feltz was also 2-for-2 in free throw attempts, had one block, attained three assists and totaled three steals.

Both William Paterson and CNU suffered numerous turnovers as the Lady Pioneers had 20 and Christopher Newport had 21.

Nadine Ward led CNU with 13 points, 10 rebounds, four assists, and two blocks.

Ward went on to complete six of 11 field goal attempts and get three steals.

CNU's Jen Harrell contributed 12 points, five rebounds, two assists and one steal. Harrell was 5-for-9 in field goal attempts and two for two in free throw attempts.

Tia Moore of CNU was not far

away with 11 points, nine rebounds, one assist, and one steal. Moore was 3-for-4 on free throw shots.

William Paterson shot 77 percent from the free throw line, whereas CNU only shot 53 percent.

This championship has enhanced the impressive record of the Lady Pioneers and foretells success in the remainder of the season.

William Paterson, under the direction of Head Coach Erin Monahan, seems to be the team to beat, but only two teams have accomplished this feat.

The Lady Pioneers will be on the road to face the Gothic Knights of New Jersey City University on Wednesday.

If you can't travel to see the Lady Pioneers this Wednesday, be sure to catch their game on Saturday, Jan. 15, against Rowan University in the Wightman Gym.

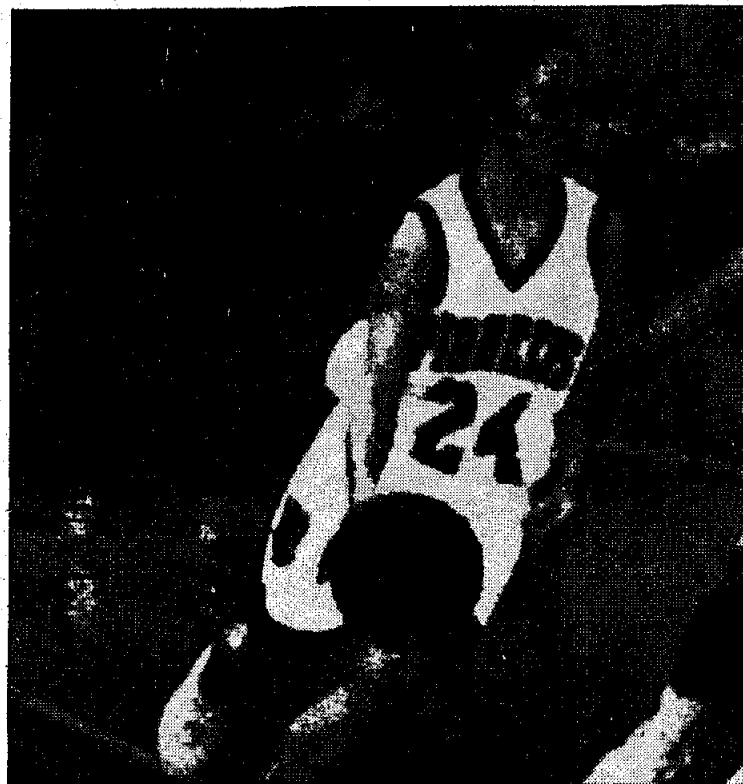

Beacon file photo

Meg Renna had a team high of 19 points to lead the Lady Pioneers in a hard fought victory over Christopher Newport University.

Pioneer ice hockey hunting for MCHC championship

Donald Bennett
Sports Contributor

After a strong first half of the season, William Paterson University looks to make a run at the Metropolitan Collegiate Hockey Conference (MCHC) title.

The Pioneers finished the first half of the season with a 5-2-1 record, for a total of 11 points. The team is currently ranked fourth overall in the conference, behind SUNY-Stonybrook, NYU and Seton Hall. With eight conference games remaining, the Pioneers have a good shot at finishing high in the standings and making a playoff run.

The team has been lead by a balanced offensive attack. Captain Bobby Carnathan leads the team with 13 points. Freshmen Chris Hagen and Jeff Rothman are also at the top of the team scoring chart with six goals and seven assists, respectively. Junior Aaron Jasper leads the team in goals with eight.

Defensively, the Pioneers have been lead by Sophomore Frank Zahn, who has played solid in the nets and is currently ranked among the elite goaltenders in the league. Assistant Captains Andy Friedman and Don Bennett have contributed to the offense, while anchoring a defensive corps that has only allowed four power play

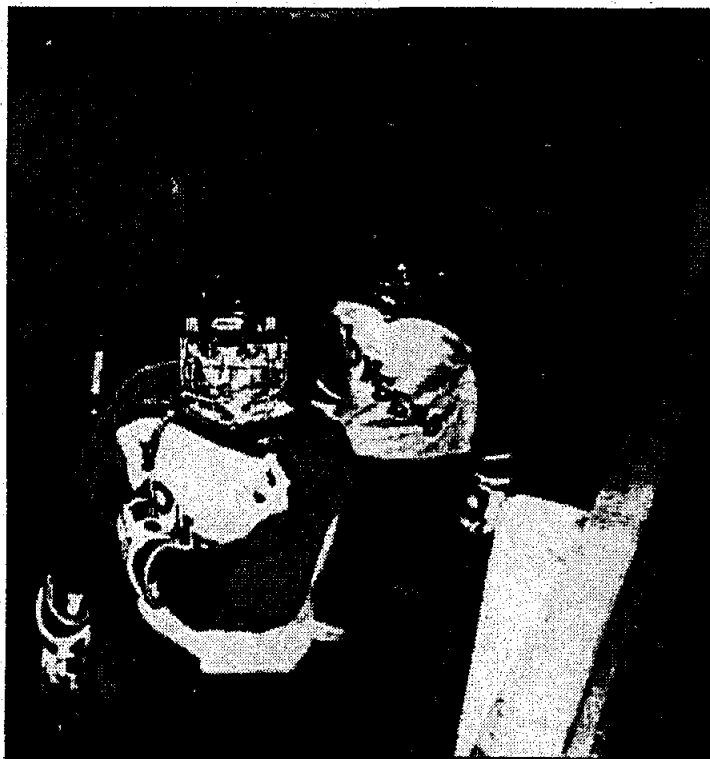

Photo courtesy of the Pioneer ice hockey team

Team Captain Bobby Carnathan leads the Pioneers to battle on the ice at Mackay Park, in Englewood.

goals against in eight games.

As the second half of the season begins, the Pioneers will be counting on physical forwards John Ozgopoyan and Craig Hoppey to step up. The team will also add transfers John Horbal and Mike Baker to the lineup.

With a solid mix of senior leaders and freshmen talent, the Pioneers hope to make a run deep into the MCHC playoffs, in search of the conference title.

WPU Basketball Wednesday, Jan. 12



at



Women's game	6:00 pm
Men's game	8:00 pm

Men and Women's Swimming



Jan. 22 @ Montclair 2:00 pm
Jan. 26 vs. Queens 6:00 pm
Jan. 29 @ Misericordia 1:00 pm
Feb. 2 @ NY Martime (Men)
7:00 pm